



BALZER & ASSOCIATES
 PLANNERS / ARCHITECTS
 ENGINEERS / SURVEYORS

Roanoke / Richmond
 New River Valley
 Shenandoah Valley
 www.balzer.cc
 80 College Street
 Suite H
 Christiansburg, VA 24073
 540.381.4290



PAVEMENT MARKING NOTES:

- STANDARD PARKING STRIPING: SURFACES SHOULD BE CLEAN AND DRY STRIPING SHALL BE 4" WIDE, COLOR WHITE
- HANDICAP PARKING STRIPING: SURFACES SHOULD BE CLEAN AND DRY STRIPING SHALL BE 4" WIDE, COLOR "HANDICAP BLUE"
- HANDICAP SYMBOL : SURFACES SHOULD BE CLEAN AND DRY SYMBOL SHALL BE MIN. 36"x36" SIZE, COLOR "HANDICAP BLUE"

NOTES:

- CONTRACTOR IS TO COORDINATE WITH ARCH PLANS FOR ROOF DRAIN CONNECTIONS.
- CONTRACTOR IS TO COORDINATE WITH ARCH PLANS FOR SPECIFIC FDC LOCATION.

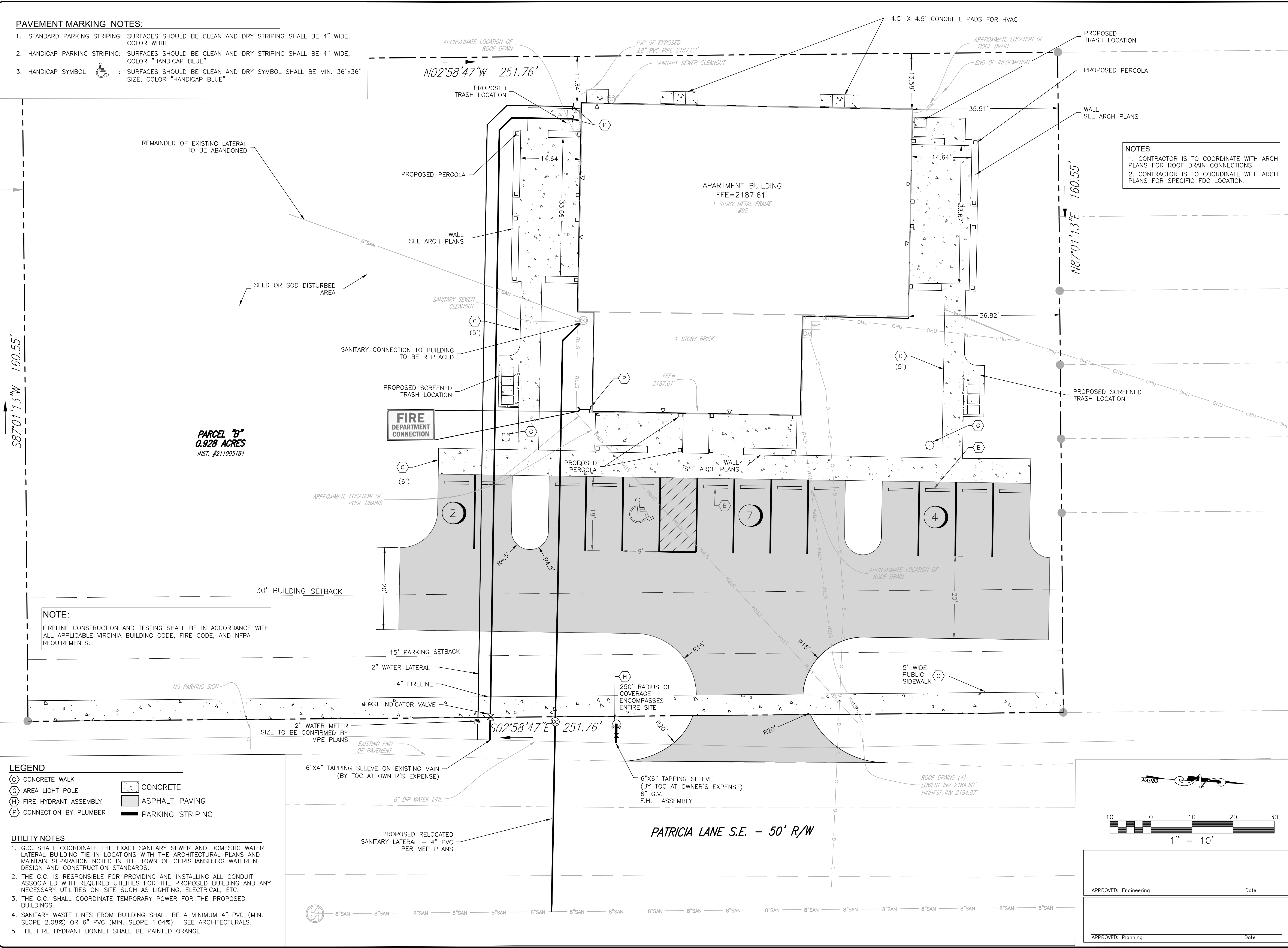

NOTE:
 FIRELINE CONSTRUCTION AND TESTING SHALL BE IN ACCORDANCE WITH ALL APPLICABLE VIRGINIA BUILDING CODE, FIRE CODE, AND NFPA REQUIREMENTS.

- LEGEND**
- CONCRETE WALK
 - AREA LIGHT POLE
 - FIRE HYDRANT ASSEMBLY
 - CONNECTION BY PLUMBER
 - CONCRETE
 - ASPHALT PAVING
 - PARKING STRIPING

- UTILITY NOTES**
- G.C. SHALL COORDINATE THE EXACT SANITARY SEWER AND DOMESTIC WATER LATERAL BUILDING TIE IN LOCATIONS WITH THE ARCHITECTURAL PLANS AND MAINTAIN SEPARATION NOTED IN THE TOWN OF CHRISTIANBURG WATERLINE DESIGN AND CONSTRUCTION STANDARDS.
 - THE G.C. IS RESPONSIBLE FOR PROVIDING AND INSTALLING ALL CONDUIT ASSOCIATED WITH REQUIRED UTILITIES FOR THE PROPOSED BUILDING AND ANY NECESSARY UTILITIES ON-SITE SUCH AS LIGHTING, ELECTRICAL, ETC.
 - THE G.C. SHALL COORDINATE TEMPORARY POWER FOR THE PROPOSED BUILDINGS.
 - SANITARY WASTE LINES FROM BUILDING SHALL BE A MINIMUM 4" PVC (MIN. SLOPE 2.08%) OR 6" PVC (MIN. SLOPE 1.04%). SEE ARCHITECTURALS.
 - THE FIRE HYDRANT BONNET SHALL BE PAINTED ORANGE.

APPROVED: Engineering _____ Date _____

APPROVED: Planning _____ Date _____

SCALE: 1" = 10'

NO. 8

PATRICIA LANE APARTMENTS
 95 PATRICIA LANE SE
 LAYOUT & UTILITY PLAN

DRAWN BY: SJW
 DESIGNED BY: SJW
 CHECKED BY: SMS
 DATE: 04/05/2022
 SCALE: 1" = 10'
 REVISIONS:
 8/10/2022

C4
 PROJECT NO. 24220025.00

J:\2024\04\24220025.00 PATRICIA LANE APARTMENTS\TOWN\24220025.00 CONSTRUCTION - CONCEPT PLATTED 8/10/2022 12:24:46 PM