

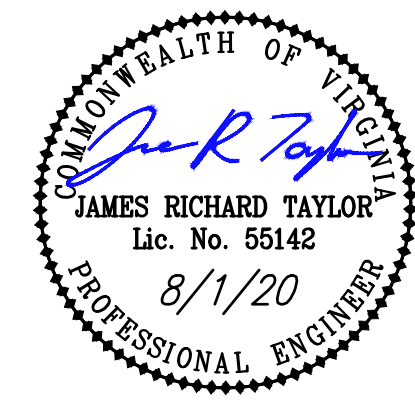

BALZER & ASSOCIATES
PLANNERS / ARCHITECTS
ENGINEERS / SURVEYORS

Roanoke / Richmond
New River Valley / Staunton
Harrisonburg / Lynchburg
www.balzer.cc
80 College Street
Suite H
Christiansburg, VA 24073
540.381.4290



MARKET PLACE BUILDING H1
2700 MARKET STREET N.E.
LAYOUT & DIMENSIONAL PLAN

SHANESVILLE MAGISTERIAL DISTRICT
TOWN OF CHRISTIANSBURG, VIRGINIA

DRAWN BY JRT
DESIGNED BY JRT
CHECKED BY SMS
DATE 11/1/19
SCALE 1" = 10'
REVISIONS
11/22/19
1/1/20
8/1/20

APPROVED: Engineering _____ Date _____
APPROVED: Planning _____ Date _____

C5

NORTH FRANKLIN STREET - U.S. RTE. 460
WIDEN TO 40' WITH 6" PAVEMENT

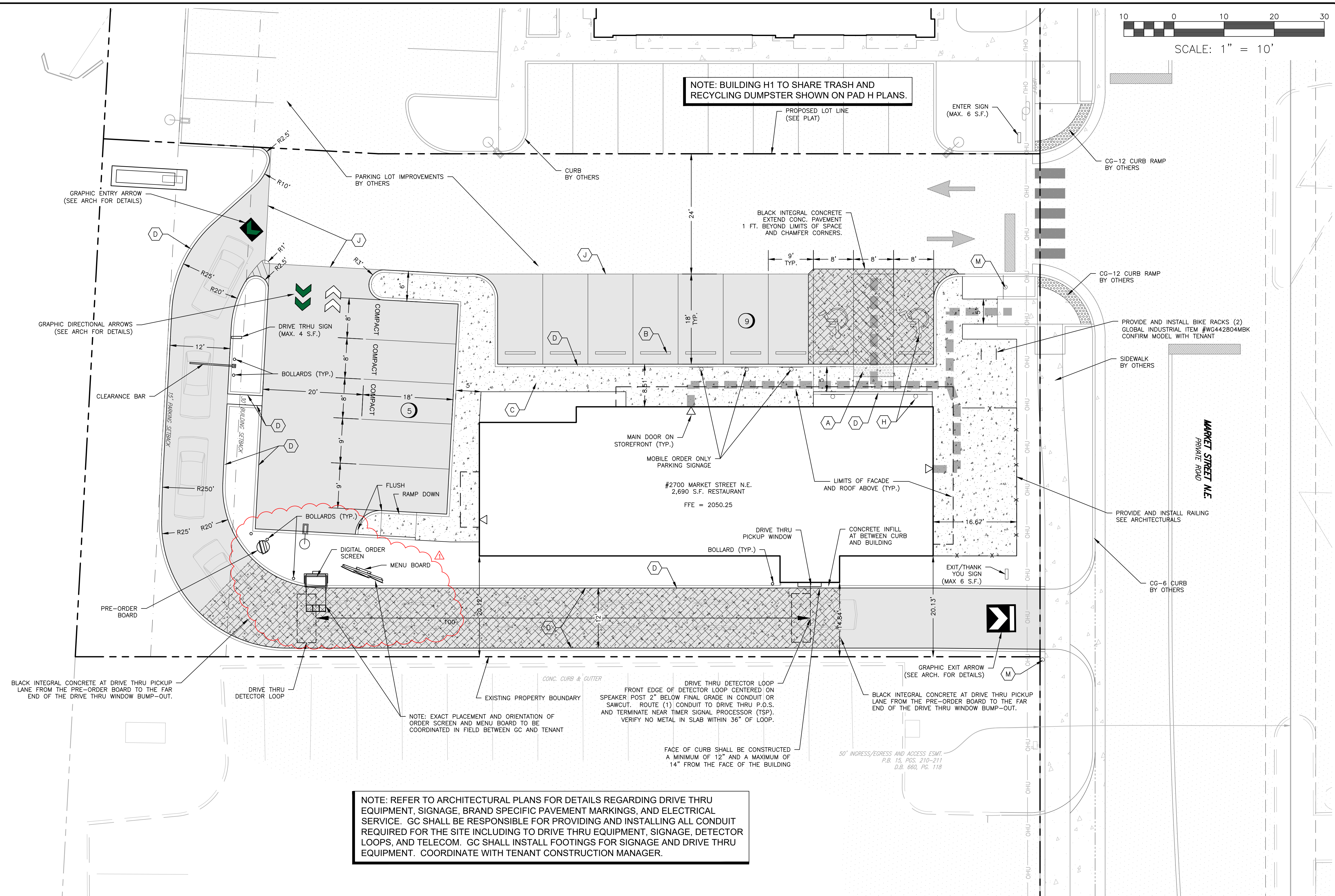

PAVEMENT MARKING NOTES:

- STANDARD PARKING STRIPING: SURFACES SHOULD BE CLEAN AND DRY STRIPING SHALL BE 4" WIDE, COLOR WHITE
- HANDICAP PARKING STRIPING: SURFACES SHOULD BE CLEAN AND DRY STRIPING SHALL BE 4" WIDE, COLOR "HANDICAP BLUE"
- HANDICAP SYMBOL : SURFACES SHOULD BE CLEAN AND DRY SYMBOL SHALL BE MIN. 36"x36" SIZE, COLOR "HANDICAP BLUE"
- HATCHED ACCESS AISLES SHALL BE PAINTED COLOR "HANDICAP BLUE".

LAYOUT PLAN NOTES

- PAVEMENT FLOW LINE RADIUS OF 5' IS TYPICAL. WHERE NO FLOW LINE EXISTS, AN EDGE OF PAVEMENT RADIUS OF 5' IS TYPICAL.
- ANY PAVEMENT OR SIDEWALK DISTURBED OR DESTROYED OUTSIDE OF THE LIMITS OF DISTURBANCE DURING THE CONSTRUCTION PROCESS SHALL BE REPLACED AS NECESSARY AT NO COST TO THE TOWN OR OFFSITE PROPERTY OWNER.
- SEE SIGNAGE PLAN BY OTHERS FOR EXACT SIZE AND HEIGHT OF SIGNS, INCLUDING BUILDING SIGNAGE. SIGNAGE SHALL BE PERMITTED SEPARATELY.
- LIGHTING SHALL BE PROVIDED IF OFF-STREET PARKING SPACES ARE TO BE USED AT NIGHT IN CONJUNCTION WITH A BUSINESS OR ACTIVITY ON THE PREMISES. LIGHTING FACILITIES SHALL BE ARRANGED AND INSTALLED, AND THE LIGHT SOURCE SHIELDED, TO MINIMIZE GLARE ON ADJACENT PROPERTY OR STREETS AND NO LIGHTING FIXTURE SHALL EXCEED A HEIGHT OF 30 FEET IN A BUSINESS DISTRICT.

LEGEND

- | | | |
|------------------------------------|-----------------------------|------------------------------|
| (A) CG-12 CURB RAMP | (H) HANDICAP PARKING & SIGN | STANDARD DUTY ASPHALT PAVING |
| (B) PARKING BUMPER BLOCK | (M) VDOT R1-1 STOP SIGN | HEAVY DUTY ASPHALT PAVING |
| (C) CONCRETE SIDEWALK 5' WIDE U.O. | (J) PAVEMENT JOINT | CONCRETE SIDEWALK |
| (D) CG-2 CURB | | CONCRETE PAVING |
| (E) CONCRETE SIDEWALK 5' WIDE U.O. | | ACCESSIBLE ROUTE |

