

NOTES:

1. ALL RADII ARE 5' UNLESS SHOWN OTHERWISE
2. CONCRETE PATTERN AT THE FRONT DOORS SHALL BE BRICKFORM.COM PATTERN NEW ENGLAND BASKET WEAVE, PRODUCT ID: FM-3600-S/O, BRICKFORM LIQUID INTEGRAL COLOR: LC-2280FRENCHGRAY.
3. ALL SIDEWALKS SHALL HAVE A WIDTH OF 5 FEET.
4. AT THE ENTRANCES, TAPER THE NEW CURB DOWN TO PAVEMENT GRADE OVER THE FINAL TWO FEET.
5. LOT DIMENSIONS AND ADJACENT OWNERS ARE SHOWN ON SHEET C1-01.

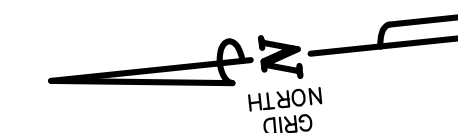

1260 Radford Street  
Christiansburg, Virginia 24073  
Phone: (540) 381-6011  
Fax: (540) 381-2773  
Email: info@gayandneel.com  
Web: www.gayandneel.com

The drawing, design, and digital files relating to this project are the property of Gay and Neel, Inc. The reproduction, copying, or other use of this drawing without GNI's written consent is prohibited.

TRU BY HILTON  
55 HAMPTON BOULEVARD, N.E.

TOWN OF CHRISTIANBURG, VIRGINIA

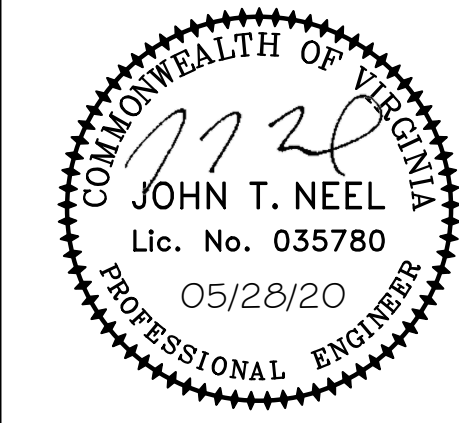

REVISIONS		
NO.	COMMENTS	DATE

PROJECT TEAM	
PIC	JOHN T. NEEL, PE
PM	BRYANT H. ALTIZER, PE, LS
DESIGN	ESD

ISSUE DATE	04/24/2020
GNI JOB NO.	3022
SHEET TITLE	SITE LAYOUT AND DIMENSION PLAN
SHEET NUMBER	C2-01

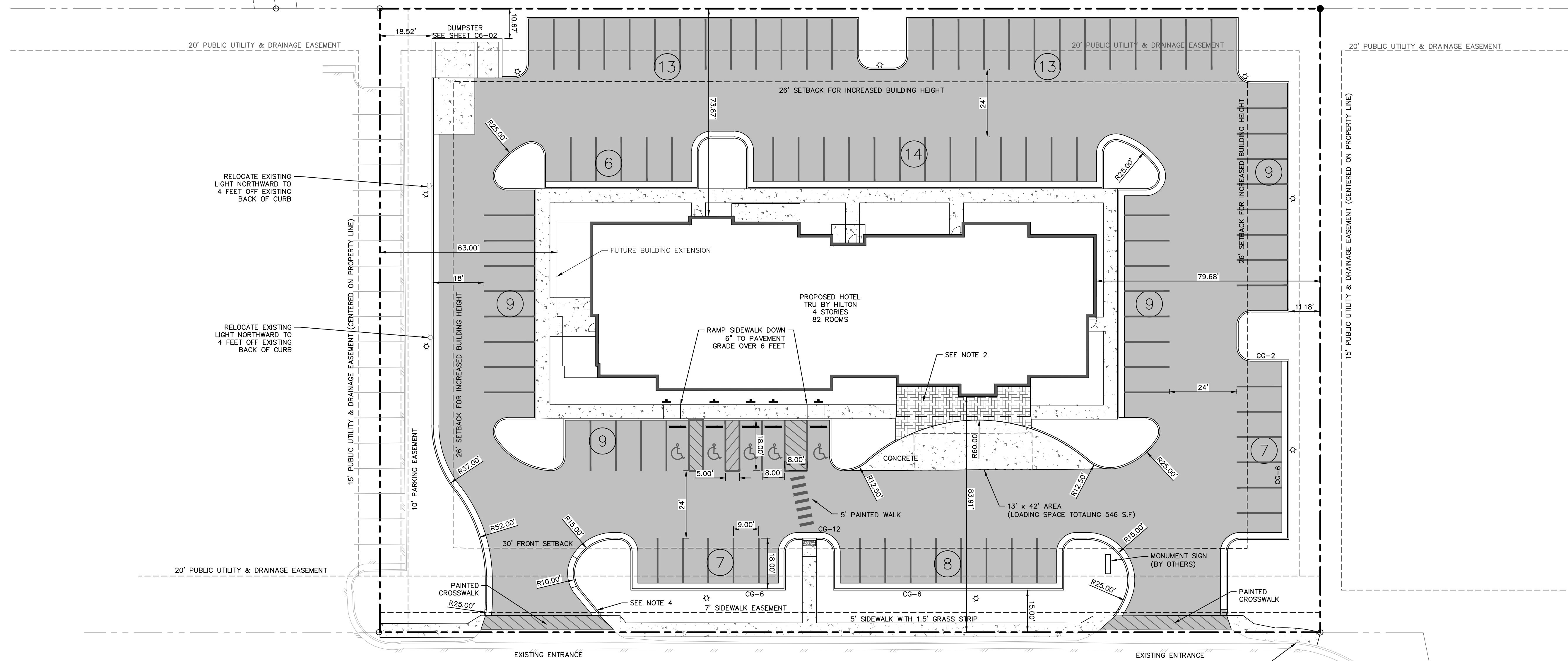

HAMPTON BOULEVARD, N.E.  
(50' PUBLIC R/W - P.B. 16 PG. 617 )

APPROVED: Engineering \_\_\_\_\_ Date \_\_\_\_\_

APPROVED: Planning \_\_\_\_\_ Date \_\_\_\_\_



X:\Drawings\3022\ENGINEERING\Design\Plans\3022\_Sht\_C2\_Site\_Layout\_Plan.dwg  
SITE LAYOUT AND DIMENSION PLAN, 05/28/2020 7:06:45 AM, Bpatterson, DWG TO PDF PLOT, 1:1