

- NOTES:
- ALL RADII ARE 5' UNLESS SHOWN OTHERWISE
 - CONCRETE PATTERN AT THE FRONT DOORS SHALL BE BRICKFORM.COM PATTERN NEW ENGLAND BASKET WEAVE, PRODUCT ID: FM-3600-S/O, BRICKFORM LIQUID INTEGRAL COLOR: LC-2280FRENCHGRAY.
 - ALL SIDEWALKS SHALL HAVE A WIDTH OF 5 FEET.
 - AT THE ENTRANCES, TAPER THE NEW CURB DOWN TO PAVEMENT GRADE OVER THE FINAL TWO FEET.
 - LOT DIMENSIONS AND ADJACENT OWNERS ARE SHOWN ON SHEET C1-01.

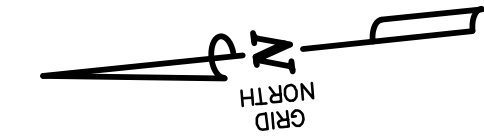

The drawing, design, and digital files relating to this project are the property of Gay and Neel, Inc. The reproduction, copying, or other use of this drawing without GNI's written consent is prohibited.

**TRU BY HILTON
 55 HAMPTON BOULEVARD, N.E.**

TOWN OF CHRISTIANSBURG, VIRGINIA

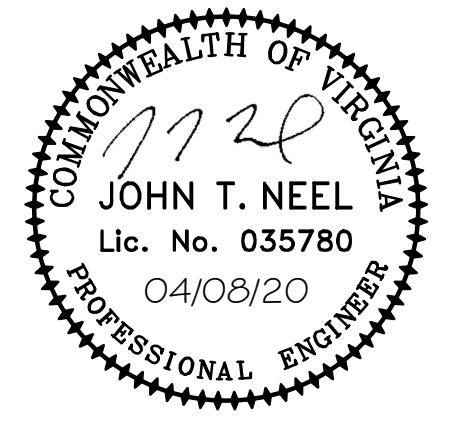

REVISIONS		
NO.	COMMENTS	DATE

PROJECT TEAM	
PIC	JOHN T. NEEL, PE
PA	BRYANT H. ALTIZER, PE, LS
DESIGN	ESD
ISSUE DATE	
04/08/2020	
GNIJOB NO.	
3022	
SHEET TITLE	
SITE LAYOUT AND DIMENSION PLAN	
SHEET NUMBER	
C2-01	

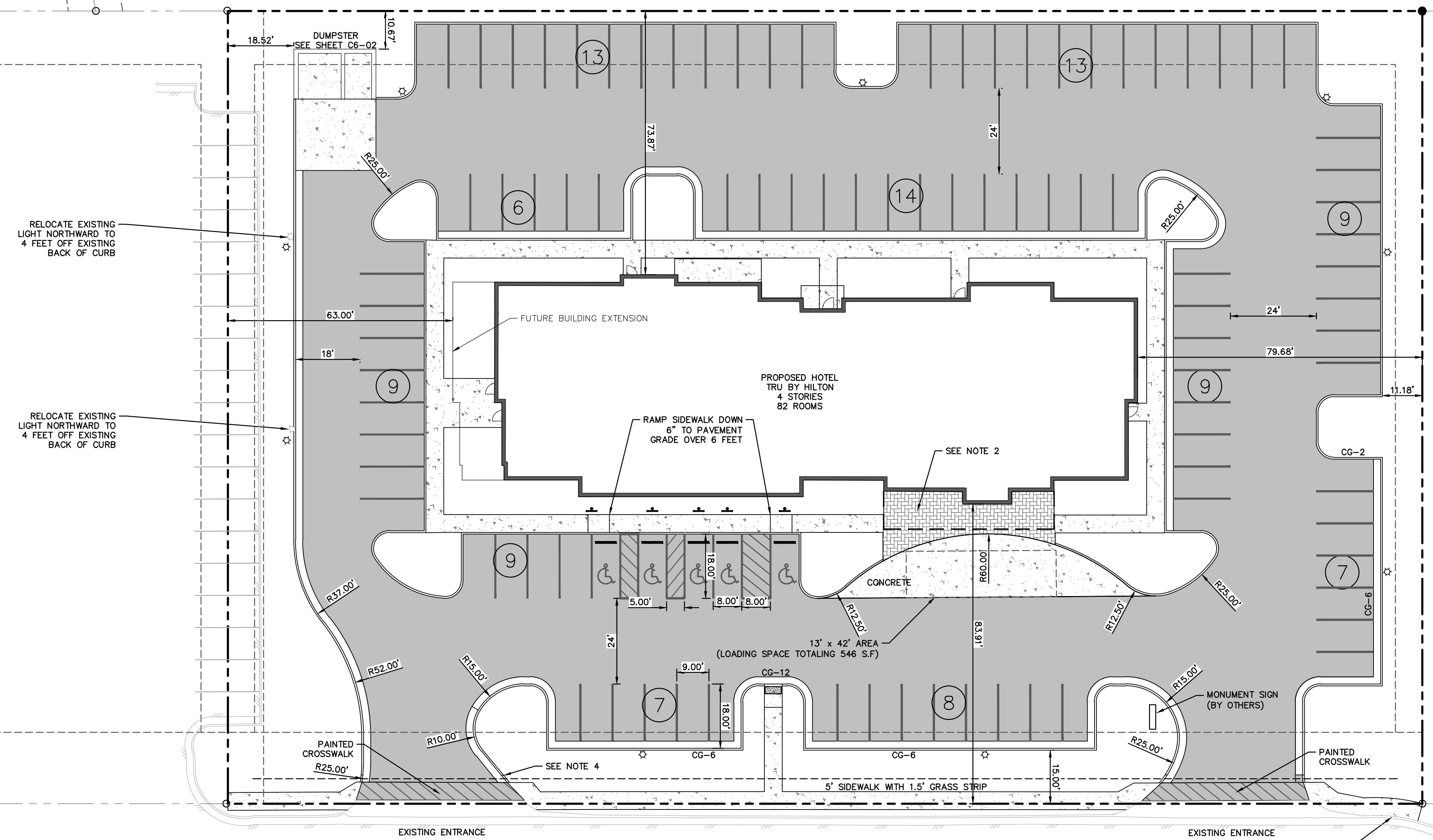

**HAMPTON BOULEVARD, N.E.
 (50' PUBLIC R/W - P.B. 16 PG. 617)**

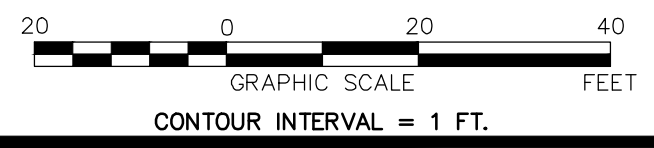

APPROVED: Engineering _____ Date _____

APPROVED: Planning _____ Date _____

X:\Drawings\3022\ENGINEERING\Design\Plans\3022_Sht_C2_Site_Layout_Plan.dwg
 SITE LAYOUT AND DIMENSION PLAN, 04/08/2020 10:17:45 AM, Eddp, DWG to PDF, 1:1